

Today's Agenda

8:00 - 8:40 am: Welcome and Introduction to Mass Timber Lateral: Scott Breneman/WoodWorks

8:40 - 9:20 am: SDPWS 2021 - General Provisions and CLT Shear Wall Systems: Omar Amini/AWC

9:20 - 10:00 am: CLT Diaphragm Design Using SDPWS 2021: Eric McDonnell/Holmes

10:00 - 10:30 am: Break

10:30-11:10 am: Mass Timber Rocking Wall Systems and Design: Reid Zimmerman/KPFF

11:10-11:50 am: NHERI 10 Story Test Building Structure and Construction: Brooke Whitsell/Timberlab

11:50 – 12:00 pm: Conclusions and Site Visit Logistics: WoodWorks



State-of-Art Mass Timber Seismic Design and the 10 Story NHERI Mass Timber Shake Table Test



Photo credit: KPFF / Reid Zimmerman

Additional Resources – WoodWorks.org

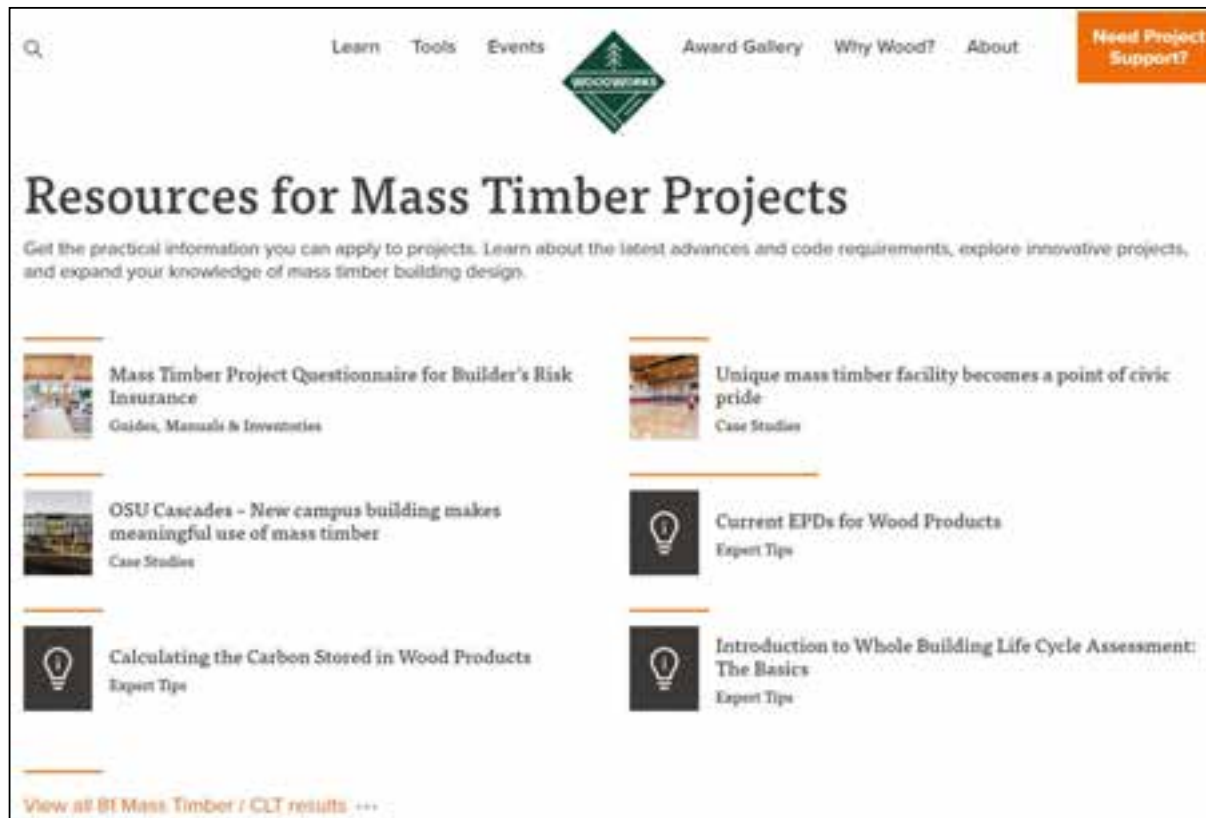







The screenshot displays the WoodWorks.org website interface. At the top, there is a navigation menu with links for 'Learn', 'Tools', 'Events', 'Award Gallery', 'Why Wood?', and 'About'. A search icon is located on the left, and a 'Need Project Support?' button is on the right. The main heading is 'Resources for Mass Timber Projects', followed by a sub-heading: 'Get the practical information you can apply to projects. Learn about the latest advances and code requirements, explore innovative projects, and expand your knowledge of mass timber building design.' Below this, there are six resource cards arranged in two columns. Each card features a small image or icon, a title, and a category label. At the bottom, there is a link to 'View all BT Mass Timber / CLT results >>>'.

Learn Tools Events  Award Gallery Why Wood? About [Need Project Support?](#)

Resources for Mass Timber Projects

Get the practical information you can apply to projects. Learn about the latest advances and code requirements, explore innovative projects, and expand your knowledge of mass timber building design.

-  **Mass Timber Project Questionnaire for Builder's Risk Insurance**
Guides, Manuals & Inventories
-  **Unique mass timber facility becomes a point of civic pride**
Case Studies
-  **OSU Cascades - New campus building makes meaningful use of mass timber**
Case Studies
-  **Current EPDs for Wood Products**
Expert Tips
-  **Calculating the Carbon Stored in Wood Products**
Expert Tips
-  **Introduction to Whole Building Life Cycle Assessment: The Basics**
Expert Tips

[View all BT Mass Timber / CLT results >>>](#)

Additional Resources – WoodWorks.org



Inventory of Fire-Resistance Tested Mass Timber Assemblies

Table 1: North American Fire Resistance Tests of Mass Timber Floor / Roof Assemblies

Test Detail	Configuration	UL/ET Grade or Timber Grade	Joist Spacing	Panel Construction	Floor Ceiling	Joist Bracing	Fire Resistance Rating (min)	Source	Testing Lab
001	2x8 (12" o.c.)	DF-55	24"	1/2" Gypsum	None	None	1	ICC-ES ESR-1114	ICC-ES
002	2x8 (12" o.c.)	DF-55	24"	1/2" Gypsum	None	None	1	ICC-ES ESR-1114	ICC-ES
003	2x8 (12" o.c.)	DF-55	24"	1/2" Gypsum	None	None	1	ICC-ES ESR-1114	ICC-ES
004	2x8 (12" o.c.)	DF-55	24"	1/2" Gypsum	None	None	1	ICC-ES ESR-1114	ICC-ES
005	2x8 (12" o.c.)	DF-55	24"	1/2" Gypsum	None	None	1	ICC-ES ESR-1114	ICC-ES
006	2x8 (12" o.c.)	DF-55	24"	1/2" Gypsum	None	None	1	ICC-ES ESR-1114	ICC-ES
007	2x8 (12" o.c.)	DF-55	24"	1/2" Gypsum	None	None	1	ICC-ES ESR-1114	ICC-ES
008	2x8 (12" o.c.)	DF-55	24"	1/2" Gypsum	None	None	1	ICC-ES ESR-1114	ICC-ES
009	2x8 (12" o.c.)	DF-55	24"	1/2" Gypsum	None	None	1	ICC-ES ESR-1114	ICC-ES
010	2x8 (12" o.c.)	DF-55	24"	1/2" Gypsum	None	None	1	ICC-ES ESR-1114	ICC-ES
011	2x8 (12" o.c.)	DF-55	24"	1/2" Gypsum	None	None	1	ICC-ES ESR-1114	ICC-ES
012	2x8 (12" o.c.)	DF-55	24"	1/2" Gypsum	None	None	1	ICC-ES ESR-1114	ICC-ES
013	2x8 (12" o.c.)	DF-55	24"	1/2" Gypsum	None	None	1	ICC-ES ESR-1114	ICC-ES
014	2x8 (12" o.c.)	DF-55	24"	1/2" Gypsum	None	None	1	ICC-ES ESR-1114	ICC-ES
015	2x8 (12" o.c.)	DF-55	24"	1/2" Gypsum	None	None	1	ICC-ES ESR-1114	ICC-ES
016	2x8 (12" o.c.)	DF-55	24"	1/2" Gypsum	None	None	1	ICC-ES ESR-1114	ICC-ES
017	2x8 (12" o.c.)	DF-55	24"	1/2" Gypsum	None	None	1	ICC-ES ESR-1114	ICC-ES
018	2x8 (12" o.c.)	DF-55	24"	1/2" Gypsum	None	None	1	ICC-ES ESR-1114	ICC-ES
019	2x8 (12" o.c.)	DF-55	24"	1/2" Gypsum	None	None	1	ICC-ES ESR-1114	ICC-ES
020	2x8 (12" o.c.)	DF-55	24"	1/2" Gypsum	None	None	1	ICC-ES ESR-1114	ICC-ES



US Mass Timber Floor Vibration Design Guide

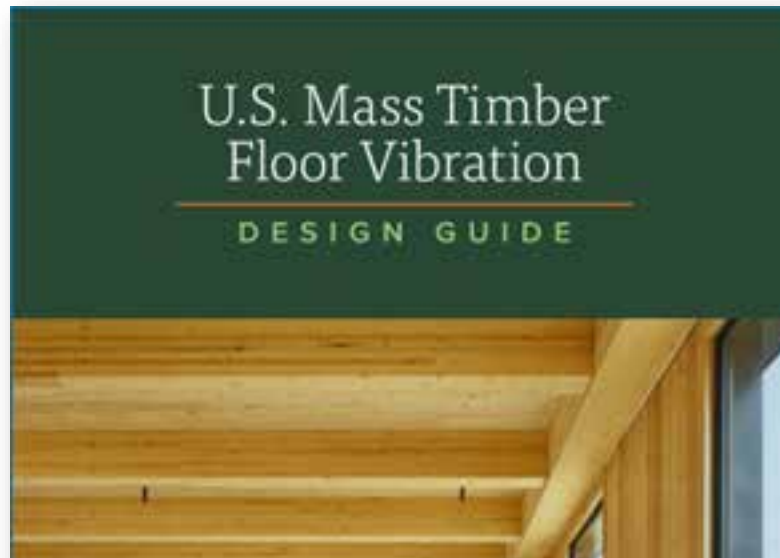
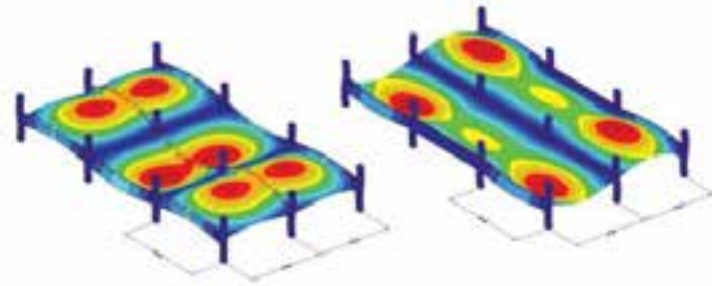

Worked office, lab and residential Examples

Covers simple and complex methods for bearing wall and frame supported floor systems

**Available for free from
www.woodworks.org/publications-media/solution-papers/**

Mass Timber Connections Index



A library of commonly used mass timber connections with designer notes and information on fire resistance, relative cost and load-carrying capacity.

WoodWorks Index of
Mass Timber Connections

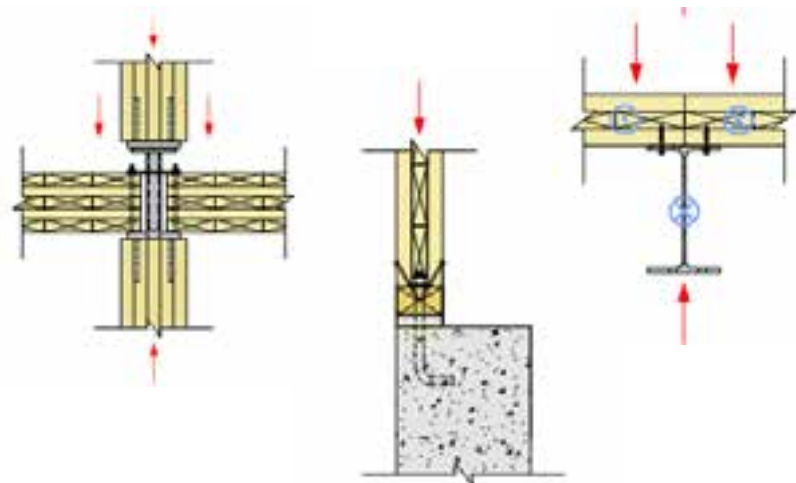



Choose building materials based on their true sustainability.

Learn about whole building life cycle assessment, biogenic carbon and EPDs at woodworks.org



Photos: Catalyst, MGA | Michael Green Architecture, photo Ben Benschneider; Plum Creek



Resources from WoodWorks

Whole Building Life Cycle Assessment (WBLCA)

- » Introduction to Whole Building Life Cycle Assessment: The Basics

Biogenic Carbon and Carbon Storage

- » When to Include Biogenic Carbon in an LCA
- » How to Include Biogenic Carbon in an LCA
- » Biogenic Carbon Accounting in WBLCA Tools
- » Long-Term Biogenic Carbon Storage
- » Calculating the Carbon Stored in Wood Products

Environmental Product Declarations (EPDs)

- » Current EPDs for Wood Products
- » How to Use Environmental Product Declarations



Scan to view

Photo: DPR Office, SmithGroup, photo Chad Davies

Regional Directors: One-on-One Project Support





**WOODWORKS
INNOVATION
NETWORK.ORG**



111 East Grand / Neumann Monson Architects
photo Mike Sinclair

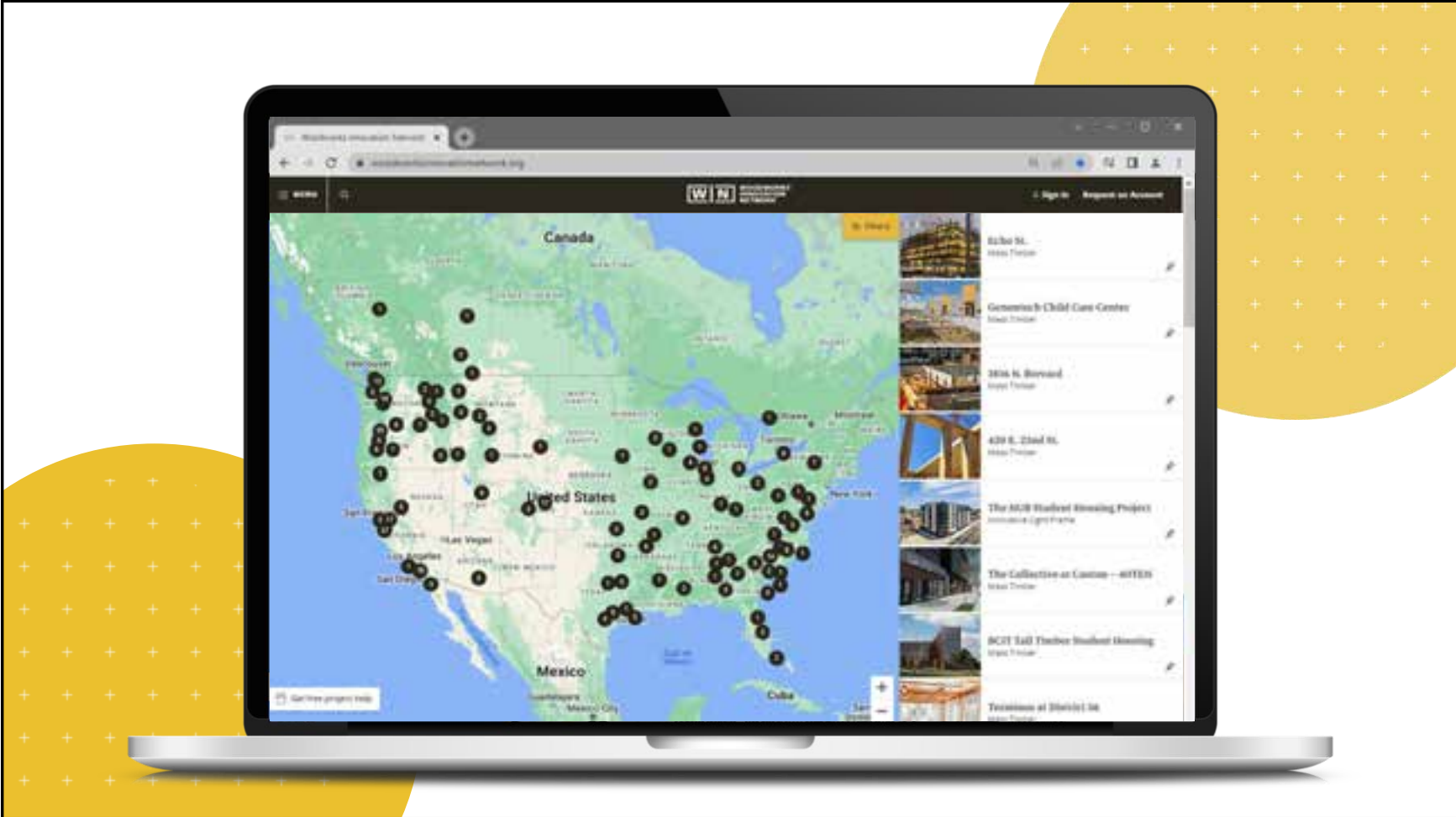

Today's Agenda

12:00 – 3:30 pm | Site Visit to 10- Story NHERI Mass Timber Shake Table

1. Bus will make a stop at San Diego Airport then return to Hilton San Diego Airport/Harbor Island.

➤ QUESTIONS?

This concludes The American
Institute of Architects Continuing
Education Systems Course

Scott Breneman

WoodWorks – Wood Products Council

Scott.Breneman@woodworks.org

Copyright Materials

This presentation is protected by US
and International Copyright laws.
Reproduction, distribution, display and use of
the presentation without written permission
of the speaker is prohibited.

© The Wood Products Council 2023

Funding provided in part by the Softwood Lumber Board

Disclaimer: The information in this presentation, including, without limitation, references to information contained in other publications or made available by other sources (collectively “information”) should not be used or relied upon for any application without competent professional examination and verification of its accuracy, suitability, code compliance and applicability by a licensed engineer, architect or other professional. Neither the Wood Products Council nor its employees, consultants, nor any other individuals or entities who contributed to the information make any warranty, representative or guarantee, expressed or implied, that the information is suitable for any general or particular use, that it is compliant with applicable law, codes or ordinances, or that it is free from infringement of any patent(s), nor do they assume any legal liability or responsibility for the use, application of and/or reference to the information. Anyone making use of the information in any manner assumes all liability arising from such use.