

Closing Plenary

Presented by Chris Duvall

COUGHLINPORTERLUNDEEN
STRUCTURAL CIVIL SEISMIC ENGINEERING

Disclaimer: This presentation was developed by a third party and is not funded by WoodWorks or the Softwood Lumber Board.

“The Wood Products Council” is a Registered Provider with The American Institute of Architects Continuing Education Systems (AIA/CES), Provider #G516.

Credit(s) earned on completion of this course will be reported to AIA CES for AIA members. Certificates of Completion for both AIA members and non-AIA members are available upon request.

This course is registered with AIA CES for continuing professional education. As such, it does not include content that may be deemed or construed to be an approval or endorsement by the AIA of any material of construction or any method or manner of handling, using, distributing, or dealing in any material or product.

Questions related to specific materials, methods, and services will be addressed at the conclusion of this presentation.



Type IV Changes – Impact to the Design Community

New Design Opportunities

Meet Market Demand

Local Products



Image credit: DLR Group

Type IV Changes – Impact to the Design Community

Utilize Small Tree Material (regrowth)

" In less than 8 hours, U.S. Timberlands can re-grow all the wood fiber consumed from all North American mass timber construction in 2018."

- 2019 State of the Industry North American Mass Timber

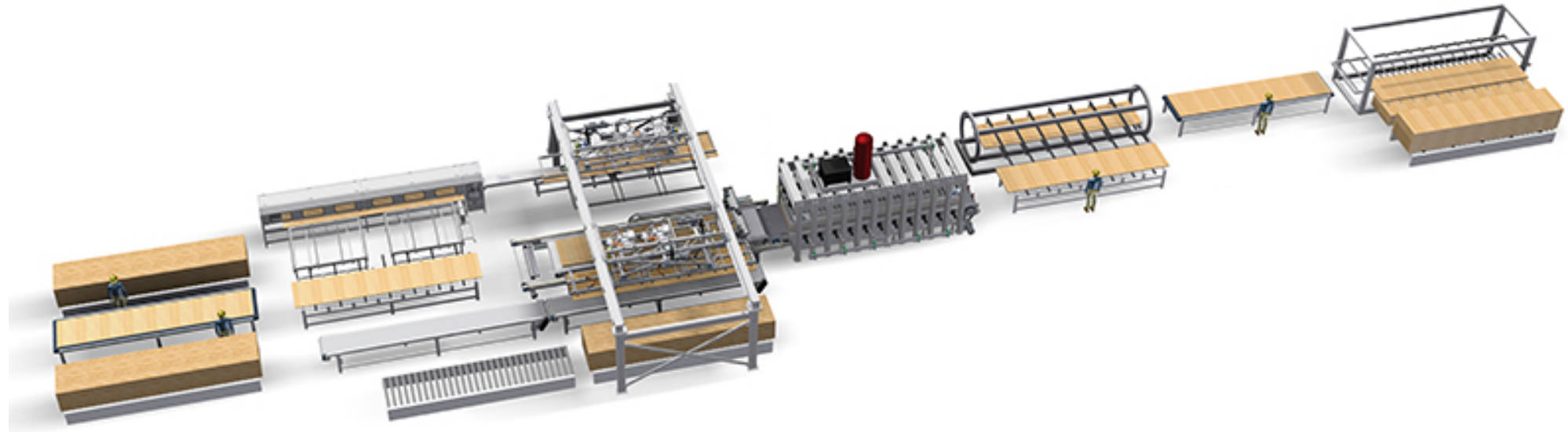

Image credit: Kallesoe A/S

Type IV Changes – Impact to the Design Community

Advancements in Technology and Fabrication

- Fire Resistant Adhesives
- Digital Manufacturing

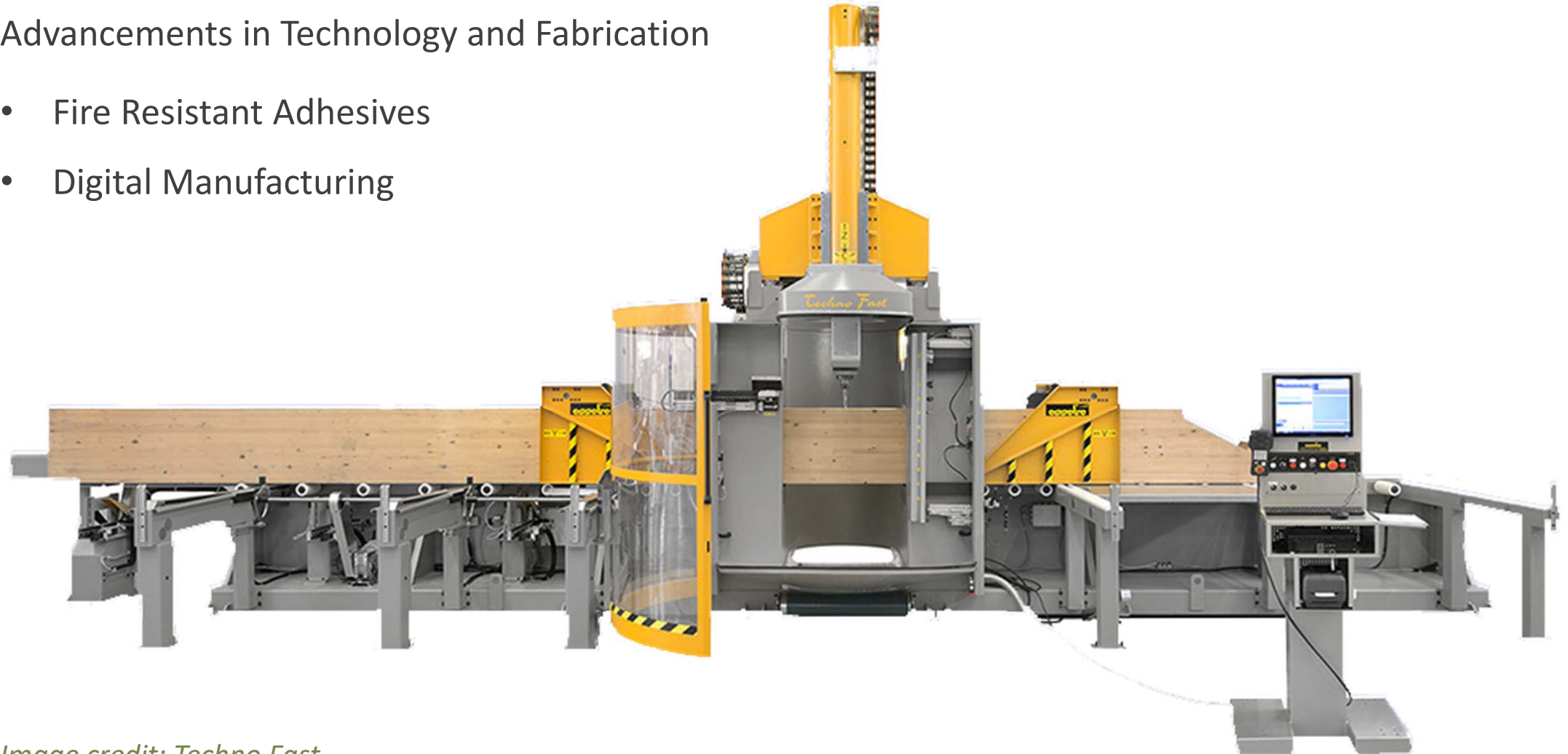

Image credit: Techno Fast

Type IV Changes – Impact to the Design Community

Provides another material option in addition to steel and concrete for building heights above 85 feet



Mass Timber Multi Family in San Francisco created for the Mission Housing Design Competition | Image credit: DLR Group San Francisco



Mjøstårnet by Voll Arkitekter in Brumunddal, Norway, has been verified as the world's tallest timber building at 280 ft

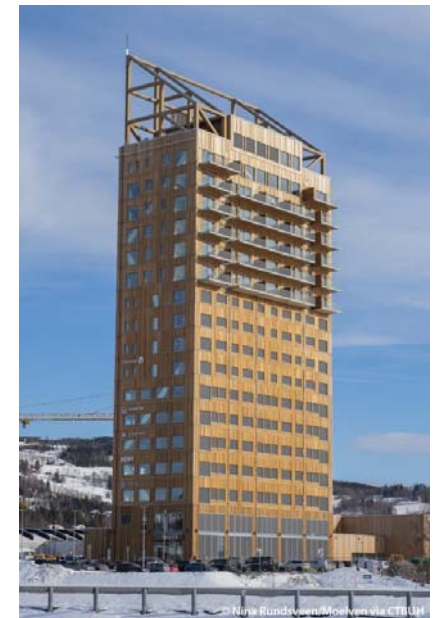

Overcoming Barriers

Emerging Industry

Re-Envisioning Wood

Seismic Codification

AHJ Approval



Tukwila Library | Coughlin Porter Lundeen

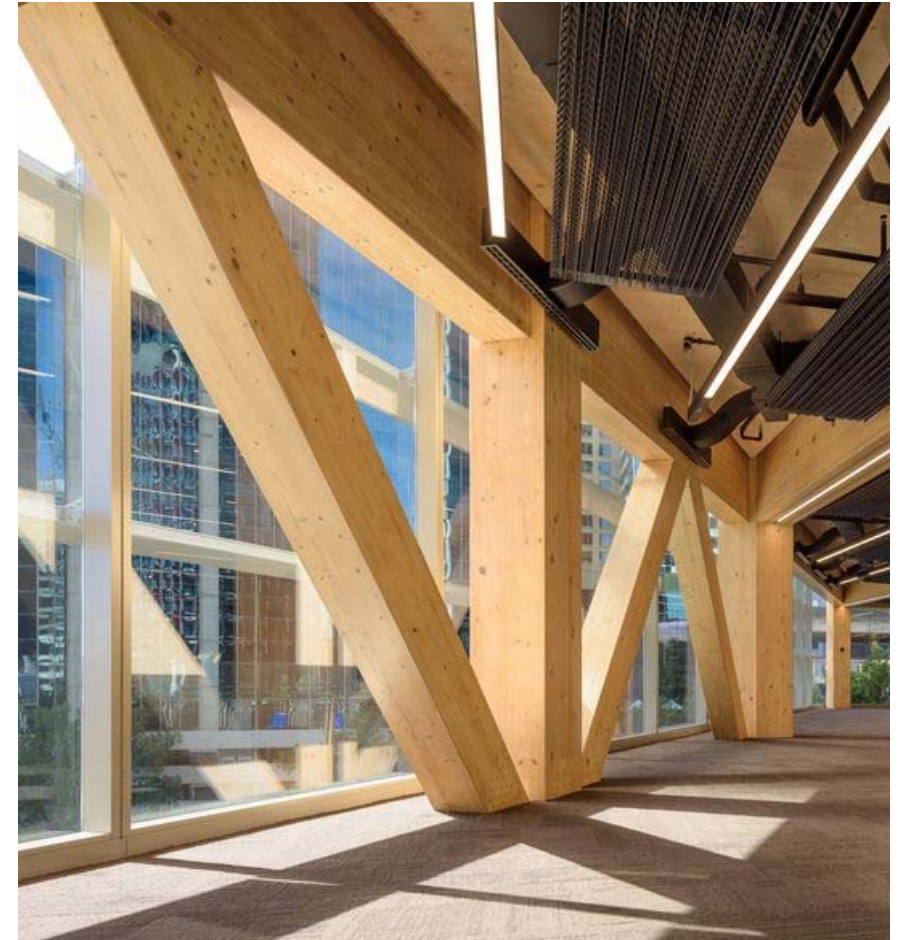

International House, Sydney | Image Credit: HESS

Overcoming Barriers

Supply Chain

Industry Familiarity/Expertise

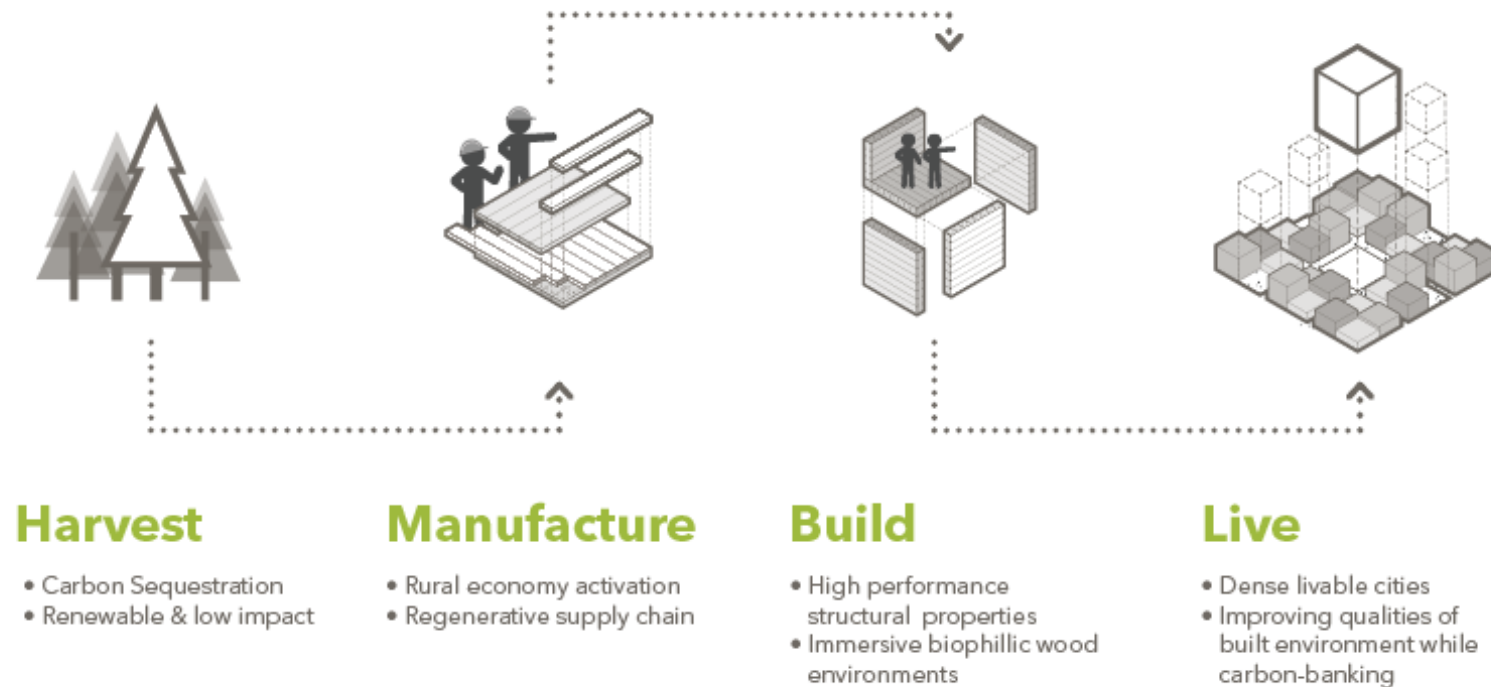

Image credit: GGLO

Overcoming Barriers

Damage/Repair Techniques

- Fire
- Water (Rot)

Tested Assemblies

- Fire
- Seismic
- Acoustics
- Vibration

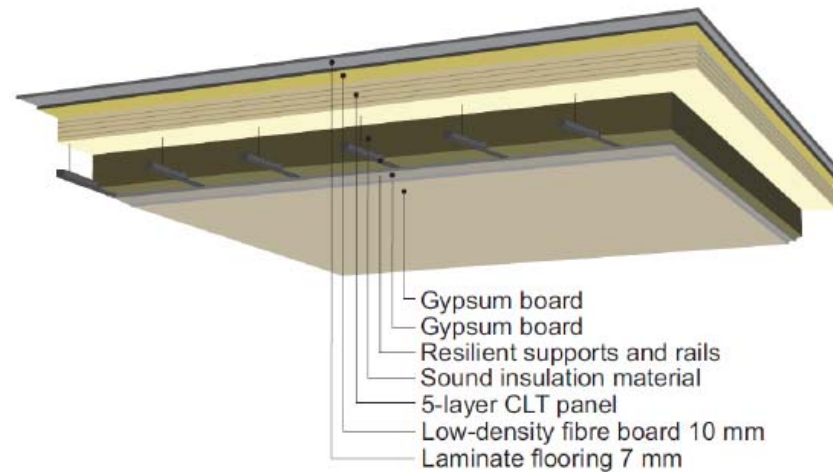

Image credit: CLT Handbook

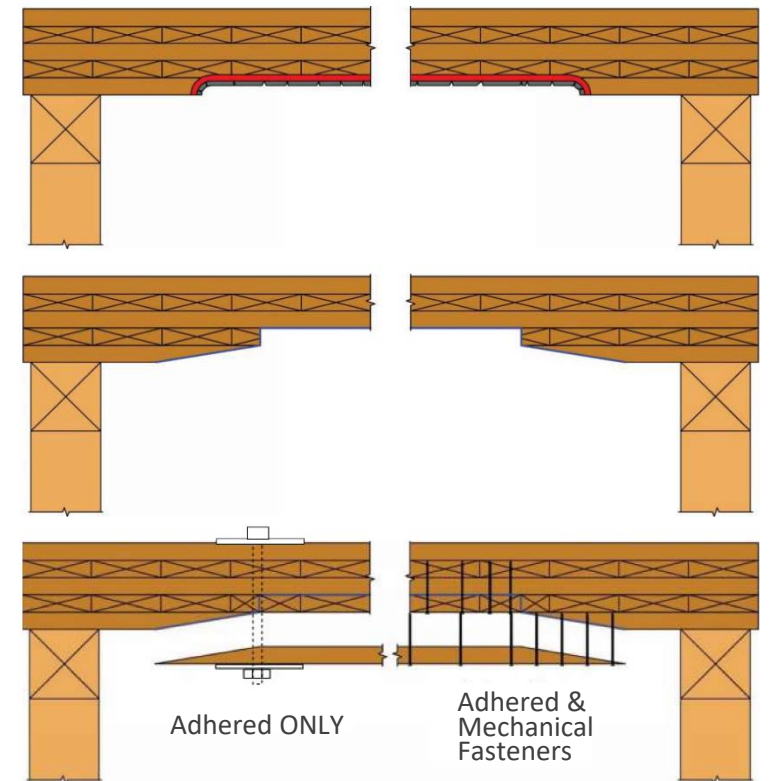

Image credit: SmartLam

> QUESTIONS?

This concludes The American Institute
of Architects Continuing Education
Systems Course

Chris Duvall

Coughlin Porter Lundeen

chrisd@cplinc.com