

TYPICAL SILL PLATE ELEVATION (A)

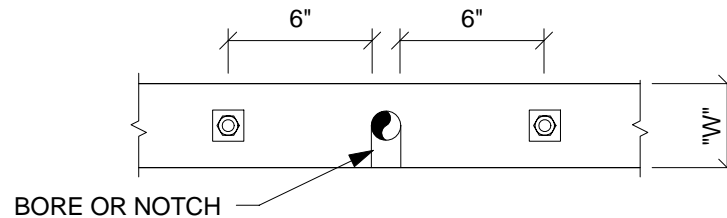

PLAN VIEW (B)

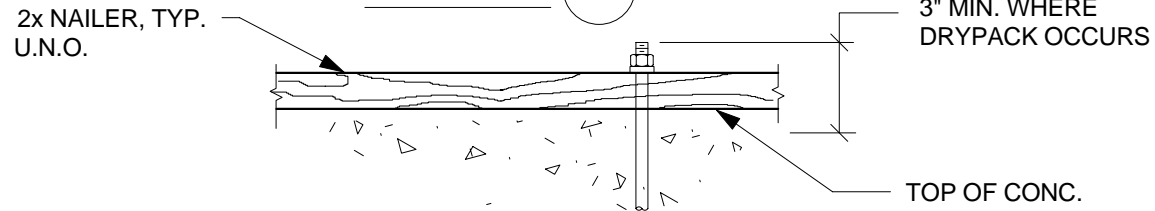

MINIMUM SILL BOLT PROJECTION (C)

SILL BOLT REQUIREMENTS

1. PROVIDE A MINIMUM SILL BOLT EMBEDMENT OF 7" BELOW FINISH FLOOR OR TOP OF CURB.
2. PROVIDE AN ADDITIONAL SILL BOLT 6 INCHES FROM EACH END OF EACH PIECE OF SILL PLATE.
3. WHERE SILL PLATES ARE BORED OR NOTCHED IN EXCESS OF 1/3 OF THE SILL PLATE WIDTH, PROVIDE ADDITIONAL SILL BOLTS 6 INCHES EACH SIDE OF BORE OR NOTCH.
4. SET ALL SILL BOLTS WITH A SETTING TEMPLATE BEFORE PLACING CONCRETE. STABBING OR PUSHING OF SILL BOLTS INTO WET CONCRETE IS EXPRESSLY PROHIBITED.
5. PROVIDE A MINIMUM SILL BOLT PROJECTION ABOVE THE CONCRETE AS SHOWN ON DETAIL C.